

REV	DESCRIPTION	DATE

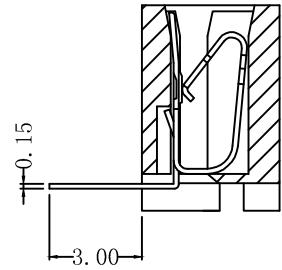

NOTE:

- MATERIAL
 HOUSING: GLASS-REINFORCED THERMOPLASTIC UL 94V-0.
 CONTACT: COPPER ALLOY.
 PLATING: TIN PLATED OVER NICKEL
- ELECTRICAL
 CURRENT RATING: 3.0AMP.
 DIELECTRIC WITHSTANDING VOLTAGE: 1000V AC MIN.
 INSULATION RESISTANCE: 1000MΩ MIN.
 CONTACT RESISTANCE: 30mΩ MAX.
- ENVIRONMENTAL
 TEMPERATURE RANGE: -25°C TO +85°C.
- PART NO.
 CNT-FPC254-XX-TD-S3-670

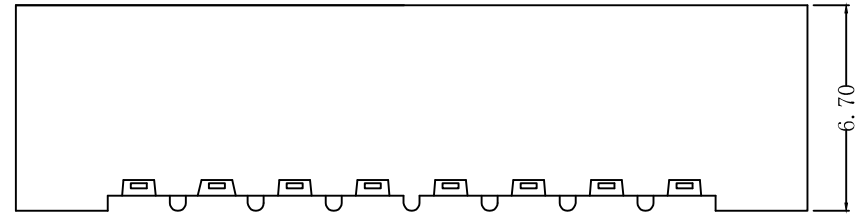
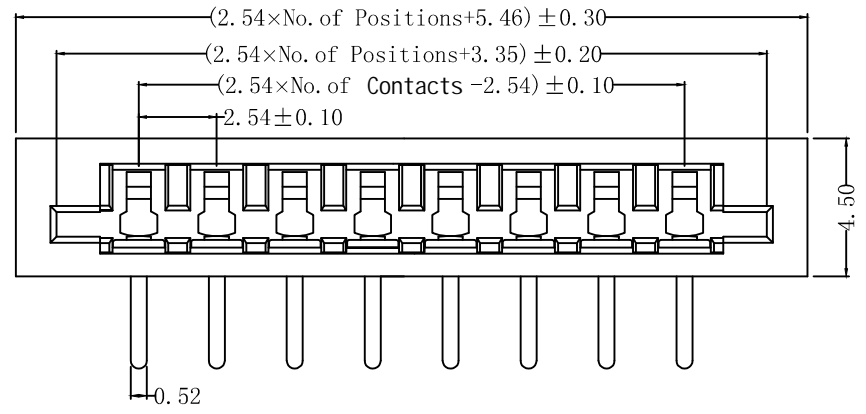
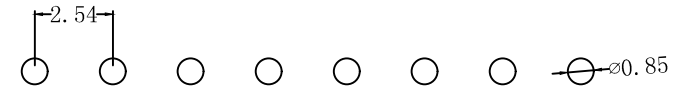

RECOMMENDED PCB LAYOUT

CNT 肯耐特电子有限公司			GENERAL TOLERANCE		DRAWN	DATE	DWG. NO.	TITLE
			X.° ±5°	X. ±0.30	董道丽	20191011		
REV. 1.0	UNIT mm	SCALE 1:1		.X° ±3°	.X ±0.38	CHECK	DATE	PART. NO. CNT-FPC254-XX-TD-S3-670
				.XX° ±2°	.XX ±0.25	王芳芳	20191011	
				.XXX° ±1°	.XXX ±0.15	王元中	20191011	